



# GX620

VHF MARINE HANDHELD RADIO



INSTRUCTION MANUAL

## CONTENTS

INTRODUCTION .....	3	Last Channel Memory (LCM) ...	13
CAUTION .....	3	Dual Watch/Triple Watch Mode	13
FEATURES .....	4	Channel Scan .....	14
STANDARD PACKAGE INCLUDES .....	4	Priority Scan .....	14
OPTIONAL ACCESSORIES.....	4	Key Beep .....	14
RADIO CONTROLS.....	5	Display & Keypad Backlight ....	15
FITTING THE BATTERY PACK.....	6	Battery Level .....	15
Fitting .....	6	Power Save .....	15
Removal .....	6	INTERNATIONAL/ USA & CANADIAN	
BATTERY CHARGING.....	7	MODES.....	15
FUNCTIONS .....	8	SAFETY REQUIREMENTS .....	16
LCD DISPLAY.....	10	TROUBLESHOOTING.....	16
BASIC RADIO OPERATIONS .....	11	INTERNATIONAL FREQUENCY	
RADIO FEATURES EXPLAINED .....	11	PLAN .....	17
Volume Level .....	11	FREQUENCY PLAN – CANADA.....	18
Function (Menu) Mode.....	11	FREQUENCY PLAN – USA.....	19
Channels .....	11	TECHNICAL SPECIFICATIONS.....	20
Power High/Low .....	12	SC CONTRACT WARRANTY	
Squelch Level Adjustment .....	12	AGAINST DEFECTS.....	22
Monitor .....	12		
Keypad Lock .....	12		
Channel 16 .....	12		

## INTRODUCTION

Congratulations on purchasing this GME fully featured VHF Marine radio. Your GX620 has been built to offer excellent value by combining advanced features, great design and manufacturing quality.

To ensure you are familiar with the operation and features of your radio, and in order to obtain the best performance, please read this manual thoroughly before operation.

## CAUTION

**IMPORTANT:** READ ALL INSTRUCTIONS carefully and completely before operating your radio and retain this manual for future reference.

**NEVER:** connect the radio to a power source other than the supplied battery. This may damage your product.

**NEVER:** operate your radio with the antenna less than 5 cm from exposed parts of the body.

**NEVER:** use the radio in or near a mining facility or other area which uses remotely triggered explosives or an area labelled 'Blasting Area'.

**NEVER:** use or charge your radio in a potentially explosive atmosphere.

**DO NOT:** place your radio in front of a vehicle air bag.

**DO NOT:** operate your radio on board an aircraft.

**DO NOT:** use your radio with a damaged antenna.

**DO NOT:** attempt to modify your radio in any way.

**ALWAYS:** charge your radio at normal room temperature.

**ALWAYS:** switch off your radio where notices restrict the use of two-way radio or mobile telephones.

**ALWAYS:** replace the accessory jack cover when the jack is not in use.

**AVOID:** submerging your radio into water. It is not submersible.

**AVOID:** storing or charging your radio in direct sunlight.

**AVOID:** storing or using your radio where temperatures are below -20° C or above +60° C.

## FEATURES

- Complete International/USA and Canadian channel plans
- Easy to read large backlit LCD
- Simple 5/1 watt switchable power
- Priority Scan
- Water resistant to IP54
- Drop in style semi-quick charger
- Flexible antenna and carry case

## STANDARD PACKAGE INCLUDES

- GX620 Radio
- Replaceable Flexible Antenna
- Li-Ion Battery Pack (1000 mAh)
- Charging Cradle
- Belt Clip
- Instruction Manual
- 12 V DC In-Dash Adapter (BCV005)

## OPTIONAL ACCESSORIES

- BCT005 – Power Adaptor
- MC005 – Speaker Microphone
- BP1700 – Li Ion Battery Pack (1700 mAh)
- LC003 – Leather Carry Case

## RADIO CONTROLS

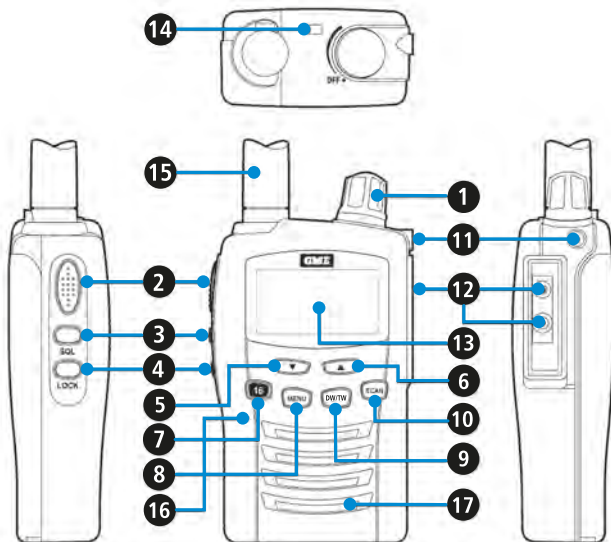

- |  |  |                             |
|--|--|-----------------------------|
| <b>1</b> Power On/Off and Volume Control knob. | <b>6</b> Up Button ▲                     | <b>12</b> Accessory Jack    |
| <b>2</b> PTT Button                            | <b>7</b> Channel 16 Button               | <b>13</b> LCD Display       |
| <b>3</b> Squelch/Monitor Button.               | <b>8</b> Menu Button                     | <b>14</b> Lanyard fix point |
| <b>4</b> Keypad Lock Button                    | <b>9</b> Dual Watch/Triple Watch Button. | <b>15</b> Antenna           |
| <b>5</b> Down Button ▼                         | <b>10</b> Scan/Priority Scan Button.     | <b>16</b> Microphone        |
|  | <b>11</b> Jack Cover                     | <b>17</b> Speaker           |

## FITTING THE BATTERY PACK

### FITTING

---

1. Ensure that your radio is switched OFF.
2. Align the bottom of the battery pack with the securing slots at the back of the radio.
3. Press the top of the battery into the back of the radio until it 'clicks' home.



### REMOVAL

---

1. Ensure that your radio is switched OFF.
2. Press down on the battery release catch and separate the battery pack from the radio.

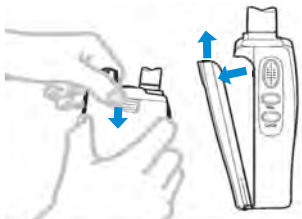

## BATTERY CHARGING

To charge your radio, there are 2 options. Prior to charging, disconnect any radio accessories and ensure the radio is switched **OFF**. Then carefully follow one of the following options:

1. Connect the 12 V in-dash adaptor to a 12 V socket:
  - a. Connect the female adaptor power plug to the charging cradle.
  - b. Insert the radio into the charging cradle until it 'clicks' home. The charger LED will glow red and charging will start. If the charger LED blinks red and green or the charger LED does not light, re-insert the radio into the charging cradle. When the battery is fully charged the charger LED will turn green.
  - c. The battery charging time is typically 4 to 5 hours.
2. Connect the 12 V in-dash adaptor to a 12 V socket:
  - a. Remove the jack cover on the side of the radio and connect the male adaptor into the top accessory jack. The charging cradle is not required for this option.
  - b. The battery charging time is typically 8 to 10 hours via the accessory jack.

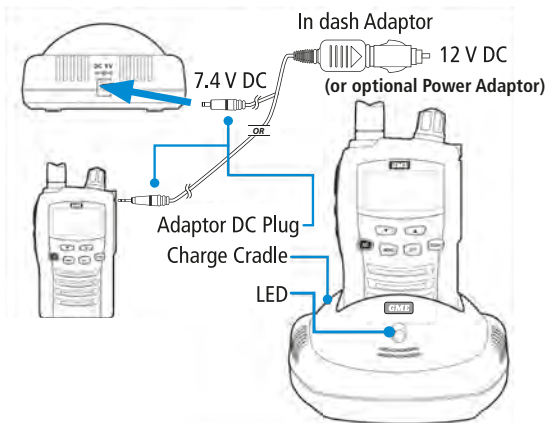

## FUNCTIONS

### 1. Power On/Off/Volume Control

---

Turn the knob clockwise to switch the radio **ON** and increase the volume, turn counter-clockwise to decrease the volume and switch the radio **OFF**. The radio will emit a confirmation tone when it switches **ON**.

### 2. Push-To-Talk (PTT) Button

---

Press and hold this button to speak (transmit) and release the button to hear (receive) messages. You can only communicate with other VHF Marine Band radios when the channel is the same as yours.

### 3. Squelch Control/Monitor Button

---

Press this button briefly to change the Squelch level in combination with ▲ and ▼ buttons. Press and hold this button to activate or deactivate the MONITOR function.

### 4. KEYPAD LOCK Button

---

Press this button briefly to activate or deactivate the keypad lock function.

### 5. DOWN Button ▼

---

Pressing this button will decrease the channel number. In some modes this button is used to adjust the function setting.



## 6. UP Button ▲

---

Pressing this button will increase the channel number. In some modes this button is used to adjust the function setting.

## 7. Channel 16 Button

---

Press this button briefly to enter the channel 16. To return to the normal channel operation, press this button briefly again.

## 8. MENU Button

---

Press this button briefly to activate the function MENU. Press the button again (repeatedly) to step through the function **MENU**. Press and hold this button to return to the previously used channel.

## 9. DUAL WATCH/TRIPLE WATCH Button (DW/TW)

---

Press this button briefly to activate and deactivate the Dual Watch. Press and hold to activate or deactivate the Triple Watch. Pressing this button briefly again during execution Triple Watch will change the mode to Dual Watch.

## 10. SCAN/PRIORITY SCAN Button

---

Press this button briefly to activate or deactivate the scan mode. For Priority scan press and hold the SCAN button. The radio will alternatively scan the Priority channel and the entire VHF Marine Band. Briefly press the scan button to stop the scan.

## LCD DISPLAY

1. Transmit Icon
2. Receiver Busy Icon
3. Monitor Icon
4. Dual Watch Icon
5. Triple Watch Icon
6. Battery Icon
7. Keypad Lock Icon
8. Scan Icon
9. Key Beep Icon
10. Priority Channel Icon
11. High Power Icon
12. Channel Indicator
13. Duplex Icon
14. Channel Plan Icons
15. Weather channels (US only).

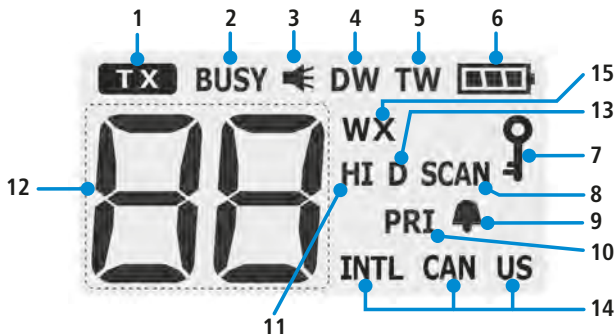

## BASIC RADIO OPERATIONS

The VHF Marine radio service shares channels on a 'take turns' basis. This means that other users and groups may be using any channel. To communicate with other Marine radios, all units must be switched to the same channel.

1. Switch your radio **on**.
2. Ensure you are on the same channel as the other party (see function Mode).
3. To speak, hold the radio upright, about 10 cm from your mouth and press the **PTT** button, the '**TX**' icon will appear in the radio display. Speak normally and clearly towards the radio. Release the **PTT** button when you finish speaking. You will hear messages from other radios that are within range on the same channel. The Busy icon will appear in the radio display when you receive a message.

## RADIO FEATURES EXPLAINED

### VOLUME LEVEL

---

To adjust the volume level, use the power ON/OFF/VOLUME control **1**. To increase the volume turn this control clockwise, to decrease the volume turn this control counter-clockwise.

### FUNCTION (MENU) MODE

---

The MENU mode allows you to set-up and edit the basic functions. To access the MENU mode, press the **MENU** button briefly. Each press of the **MENU** button steps the radio sequentially through the different functions. The radio display indicates the current function, the present setting and associated icon flash. Use the **▲** or **▼** button to change the setting. Press the **PTT** or **MENU** button or wait for 5 seconds to store your choice. If you do not press any key for 5 seconds your radio will return to stand-by mode automatically.

### CHANNELS

---

This radio operates on any one of the VHF Marine Band radio channels. To communicate with other VHF Marine radios, all units must be switched to the same channel. To change the radio channel, press the **▲** or **▼** button when the radio is in stand-by mode.

## POWER HIGH/LOW

---

This feature permits selection of the transmit power level to HIGH (5 watts) or LOW (1 watt). The LCD indicator will display 'HI' when it is in the high power mode. Using low power, the radio will have a lower transmit range but the battery life will be increased.

Press both the **PTT** button and the ▼ button to select LOW power. The LCD indicator, 'HI' will disappear. To return to high power, press again the **PTT** and ▲ button.

## SQUELCH LEVEL ADJUSTMENT

---

This function allows you to adjust the Squelch level of your radio. To change the Squelch level, press the **Squelch/Monitor** button briefly. The current Squelch setting will appear. Use the ▲ or ▼ button to change the setting. Press the **PTT** button or wait for 5 seconds to store your choice. There are 8 Squelch levels. Level 91 is the most sensitive (open) and level 98 is the least sensitive (closed). Auto (Ao) is the optimum factory setting and 'Off' is fully open, with constant static noise.

## MONITOR

---

The Monitor function is used to briefly check for activity on the current channel. It is the same as setting the Squelch level to level 91 or fully open.

To activate or deactivate the Monitor press the **Squelch/Monitor** button ③ for about 2 seconds. The Monitor icon '🔊' will appear and you will hear background static noise.

## KEYPAD LOCK

---

To toggle the Keypad Lock, briefly press **Keypad Lock** ④ button. The Keypad Lock icon '🔒' appears when the lock is on.

## CHANNEL 16

---

The channel 16 (Distress channel) ⑦ is used to initially contact another radio station for emergency communications. This channel is automatically monitored during Dual Watch and Triple Watch. Upon stand-by, you must monitor channel 16.

## LAST CHANNEL MEMORY (LCM)

---

The previously used channel is memorised every time you press the **PTT** button. To re-visit this channel press and hold the **MENU** button **8**.

## DUAL WATCH AND TRIPLE WATCH MODE

---

**Dual Watch mode** allows you to monitor two channels; a Working channel and Dual Watch channel. The Dual Watch channel must be channel 16, this is preset by factory default. When a signal is received on either channel the unit will pause before resuming Dual Watch.

To activate Dual Watch mode, first select a radio channel (see 'Channels') as the Working channel. This is done by simply selecting a channel using the **▲** or **▼** keys. Once you have selected the Working channel, a brief press of the **DW/TW** key will activate the Dual Watch.

The radio display will alternate between the Working channel and channel 16. The Dual Watch icon '**DW**' will appear in the radio display.

To deactivate Dual Watch press the **DW/TW** button briefly again.

**Triple Watch mode** allows you to monitor three channels; a Working channel, the Dual Watch channel (channel 16) and a Priority channel that you can select. A selected Priority channel is working as the third channel. If the third channel (one Priority channel) has not been selected, the Triple Watch will not start and there will be an error beep.

When a signal is received on one channel among the three, the unit will pause before resuming the Triple Watch.

To activate **Triple Watch mode** first select a Working channel, this is done by simply selecting a channel using the **▲** or **▼** keys. Then select a Priority channel, this is done by pressing the **MENU** button once then selecting a channel by using the **▲** or **▼** keys. Once a Priority channel has been selected, press the **PTT** button or wait for 5 seconds to store your choice. Press and hold the **DW/TW** button. The radio display will alternate among the Working channel, channel 16 and the Priority channel. The Triple Watch icon '**TW**' will appear.

To deactivate Triple Watch press and hold the **DW/TW** button again. Pressing the **DW/TW** button briefly will select Dual Watch mode.

If you press the **PTT** button whilst receiving a signal in Dual Watch or Triple Watch mode the radio will transmit on the currently displayed channel. If you press the **PTT** button when no signal is present the radio will transmit on the Working channel. Dual Watch and Triple Watch will resume approximately 5 seconds after the transmission.

## CHANNEL SCAN

---

The Channel Scan can be used to find or detect users on other radio channels. To activate/deactivate the Channel Scan, press the **Scan** button briefly. The Scan icon 'SCAN' will appear when the Channel Scan is active. Scanning will only stop when you deactivate the Scan function. The radio will scan through the whole VHF Marine Band channels. If your radio detects a valid signal the Scan will pause for about 5 seconds. If you press the **PTT** button when your radio detects a signal, the radio will transmit on the same channel. Press the **▲** or **▼** button to resume scanning immediately. If you press the **PTT** button during scanning, an error beep will be heard and your radio will continue to scan.

## PRIORITY SCAN

---

Priority Scan allows the user to scan all channels whilst monitoring the Priority channel. In between each channel being scanned, the radio scans the Priority channel. Select a Priority channel, this is done by pressing the **MENU** button once then selecting a channel by using the **▲** or **▼** keys. Press the **PTT** button or wait for 5 seconds to store your choice. Then press and hold the Scan button for 2 seconds, the radio will commence Priority Scan.

The Priority channel icon 'PRI' will appear when one Priority channel has been selected.

## KEY BEEP

---

If the Key Beep is activated, your radio will emit a confirmation tone whenever you use the keypad. You can activate or deactivate the Key Beep as required.

To change the Key Beep setting, press the **MENU** button until the Key Beep icon '🔔' appears. Use the ▲ or ▼ button to change the setting. Press the **PTT** or **MENU** button or wait for 5 seconds to store your choice.

The Key Beep icon '🔔' will appear when Key Beep is active.

## DISPLAY & KEYPAD BACKLIGHT

---

The display and keypad backlight will illuminate for 5 seconds whenever any button (except for the **PTT** button) is pressed.

## BATTERY LEVEL

---

The Battery icon '' indicates when the battery level is low and the battery needs recharging.

## POWER SAVE

---

To conserve battery power the radio will automatically enter Power Save mode after a short period of inactivity. There is no user setting for Power Save.

## INTERNATIONAL/USA AND CANADIAN MODES

The GX620 comes with the International Channel Plan (INTL) as the default setting. Canada or the USA Channel Plans can be accessed (this includes the relevant weather channels) as follows:

1. Press and hold **MENU** and **LOCK KEYS** together, turn the radio **ON**.
2. Use up ▲ or ▼ keys to change the mode: International 1 (No Display), International 2 (INTL), Canada (CAN) and USA (US). International 1 and International 2 Channel Plans are equivalent to each other.
3. Press the **MENU** key to confirm.
4. Turn the radio **OFF**.
5. Turn the radio **ON**.

## SAFETY REQUIREMENTS

For recharging the battery, use the specifically supplied GME in-dash adaptor or the optional GME AC power adapter.

## TROUBLESHOOTING

If you experience problems with your GX620 VHF Marine Handheld Radio. First check the battery power level as low battery can cause problems such as poor transmission, weak reception and reduced sound quality. Then check the manual and radio display to ensure that a function (such as 'Lock') has not been activated by accident.

If these steps do not solve the problem reset your unit as follows:

1. Switch the radio **OFF**.
2. Press and hold the **MENU** button, ▼ button and **PTT** button together.
3. Switch the radio **ON** and press the **MENU** button.
4. Turn the radio **OFF** and turn it **ON** again.

This will reset the radio to the factory settings and should resolve most problems.



## INTERNATIONAL FREQUENCY PLAN

CH	Frequency (MHz)		CH	Frequency (MHz)	
	Transmit	Receive		Transmit	Receive
<b>1</b>	156.050	160.650	<b>61</b>	156.075	160.675
<b>2</b>	156.100	160.700	<b>62</b>	156.125	160.725
<b>3</b>	156.150	160.750	<b>63</b>	156.175	160.775
<b>4</b>	156.200	160.800	<b>64</b>	156.225	160.825
<b>5</b>	156.250	160.850	<b>65</b>	156.275	160.875
<b>6</b>	156.300	156.300	<b>66</b>	156.325	160.925
<b>7</b>	156.350	160.950	<b>67</b>	156.375	156.375
<b>8</b>	156.400	156.400	<b>68</b>	156.425	156.425
<b>9</b>	156.450	156.450	<b>69</b>	156.475	156.475
<b>10</b>	156.500	156.500	<b>70</b>	RX Only	156.525
<b>11</b>	156.550	156.550	<b>71</b>	156.575	156.575
<b>12</b>	156.600	156.600	<b>72</b>	156.625	156.625
<b>13</b>	156.650	156.650	<b>73</b>	156.675	156.675
<b>14</b>	156.700	156.700	<b>74</b>	156.725	156.725
<b>15</b>	156.750	156.750	<b>75</b>	156.775	156.775
<b>16</b>	156.800	156.800	<b>76</b>	156.825	156.825
<b>17</b>	156.850	156.850	<b>77</b>	156.875	156.875
<b>18</b>	156.900	161.500	<b>78</b>	156.925	161.525
<b>19</b>	156.950	161.550	<b>79</b>	156.975	161.575
<b>20</b>	157.000	161.600	<b>80</b>	157.025	161.625
<b>21</b>	157.050	161.650	<b>81</b>	157.075	161.675
<b>22</b>	157.100	161.700	<b>82</b>	157.125	161.725
<b>23</b>	157.150	161.750	<b>83</b>	157.175	161.775
<b>24</b>	157.200	161.800	<b>84</b>	157.225	161.825
<b>25</b>	157.250	161.850	<b>85</b>	157.275	161.875
<b>26</b>	157.300	161.900	<b>86</b>	157.325	161.925
<b>27</b>	157.350	161.950	<b>87</b>	157.375	157.375
<b>28</b>	157.400	162.000	<b>88</b>	157.425	157.425
<b>60</b>	156.025	160.625			

## FREQUENCY PLAN - CANADA

CH	Frequency (MHz)		CH	Frequency (MHz)	
	Transmit	Receive		Transmit	Receive
<b>WX01</b>	Weather Channel	163.275	<b>23</b>	157.150	161.750
<b>WX02</b>	Weather Channel	162.550	<b>24</b>	157.200	161.800
<b>WX03</b>	Weather Channel	162.400	<b>25</b>	157.250	161.850
<b>WX04</b>	Weather Channel	162.475	<b>26</b>	157.300	161.900
<b>WX05</b>	Weather Channel	162.425	<b>27</b>	157.350	161.950
<b>WX06</b>	Weather Channel	162.450	<b>28</b>	157.400	162.000
<b>WX07</b>	Weather Channel	162.500	<b>60</b>	156.025	160.625
<b>WX08</b>	Weather Channel	162.525	<b>61</b>	156.075	156.075
<b>WX09</b>	Weather Channel	161.650	<b>62</b>	156.125	156.125
<b>WX10</b>	Weather Channel	161.775	<b>64</b>	156.225	156.225
<b>1</b>	156.050	160.650	<b>65</b>	156.275	156.275
<b>2</b>	156.100	160.700	<b>66</b>	156.325	156.325
<b>3</b>	156.150	160.750	<b>67</b>	156.375	156.375
<b>4</b>	156.200	156.200	<b>68</b>	156.425	156.425
<b>5</b>	156.250	156.250	<b>69</b>	156.475	156.475
<b>6</b>	156.300	156.300	<b>70</b>	RX Only	156.525
<b>7</b>	156.350	156.350	<b>71</b>	156.575	156.575
<b>8</b>	156.400	156.400	<b>72</b>	156.625	156.625
<b>9</b>	156.450	156.450	<b>73</b>	156.675	156.675
<b>10</b>	156.500	156.500	<b>74</b>	156.725	156.725
<b>11</b>	156.550	156.550	<b>77</b>	156.875	156.875
<b>12</b>	156.600	156.600	<b>78</b>	156.925	156.925
<b>13</b>	156.650	156.650	<b>79</b>	156.975	156.975
<b>14</b>	156.700	156.700	<b>80</b>	157.025	157.025
<b>15</b>	156.750	156.750	<b>81</b>	157.075	157.075
<b>16</b>	156.800	156.800	<b>82</b>	157.125	157.125
<b>17</b>	156.850	156.850	<b>83</b>	157.175	157.175
<b>18</b>	156.900	161.500	<b>84</b>	157.225	161.825
<b>19</b>	156.950	161.550	<b>85</b>	157.275	161.875
<b>20</b>	157.000	161.600	<b>86</b>	157.325	161.925
<b>21</b>	157.050	157.050	<b>87</b>	157.375	161.975
<b>22</b>	157.100	157.100	<b>88</b>	157.425	162.025

## FREQUENCY PLAN - USA

CH	Frequency (MHz)		CH	Frequency (MHz)	
	Transmit	Receive		Transmit	Receive
<b>WX01</b>	Weather Channel	163.275	<b>24</b>	157.200	161.800
<b>WX02</b>	Weather Channel	162.550	<b>25</b>	157.250	161.850
<b>WX03</b>	Weather Channel	162.400	<b>26</b>	157.300	161.900
<b>WX04</b>	Weather Channel	162.475	<b>27</b>	157.350	161.950
<b>WX05</b>	Weather Channel	162.425	<b>28</b>	157.400	162.000
<b>WX06</b>	Weather Channel	162.450	<b>61</b>	156.075	156.075
<b>WX07</b>	Weather Channel	162.500	<b>63</b>	156.175	156.175
<b>WX08</b>	Weather Channel	162.525	<b>64</b>	156.225	156.225
<b>WX09</b>	Weather Channel	161.650	<b>65</b>	156.275	156.275
<b>WX10</b>	Weather Channel	161.775	<b>66</b>	156.325	156.325
<b>1</b>	156.050	156.050	<b>67</b>	156.375	156.375
<b>3</b>	156.150	156.150	<b>68</b>	156.425	156.425
<b>5</b>	156.250	156.250	<b>69</b>	156.475	156.475
<b>6</b>	156.300	156.300	<b>70</b>	RX Only	156.525
<b>7</b>	156.350	156.350	<b>71</b>	156.575	156.575
<b>8</b>	156.400	156.400	<b>72</b>	156.625	156.625
<b>9</b>	156.450	156.450	<b>73</b>	156.675	156.675
<b>10</b>	156.500	156.500	<b>74</b>	156.725	156.725
<b>11</b>	156.550	156.550	<b>77</b>	156.875	156.875
<b>12</b>	156.600	156.600	<b>78</b>	156.925	156.925
<b>13</b>	156.650	156.650	<b>79</b>	156.975	156.975
<b>14</b>	156.700	156.700	<b>80</b>	157.025	157.025
<b>15</b>	RX Only	156.750	<b>81</b>	RX Only	157.075
<b>16</b>	156.800	156.800	<b>82</b>	157.125	161.725
<b>17</b>	156.850	156.850	<b>83</b>	RX Only	157.175
<b>18</b>	156.900	156.900	<b>84</b>	157.225	161.825
<b>19</b>	156.950	156.950	<b>85</b>	157.275	161.875
<b>20</b>	157.000	157.000	<b>86</b>	157.325	161.925
<b>21</b>	157.050	157.050	<b>87</b>	157.375	161.975
<b>22</b>	157.100	157.100	<b>88</b>	157.425	157.425
<b>23</b>	157.150	157.150			

## GENERAL

---

Complies with: AS/NZS 4415.2:2003

Frequency Range: 156.025 to 162.025 MHz

Channel Set: International Channels, USA, Canada, USA weather channels.

Modulation: FM

Frequency Stability:  $\pm 5.0$  ppm

Dual Watch: Monitor time - 180 ms/over 2 sec.

Scan Speed: 10 ch/sec.

Channel Spacing: 25 kHz

Supply Voltage Range: Int. battery 7.4 V DC nom.

Battery Life Stand-by: 9 hours

Current Drain: Stand-by: 40 mA

Receive: 150 mA

Transmit: 1.4 A @ Hi 550 mA @ Lo

## TRANSMITTER

---

Output Power: Low 1 watt, High 4.8 watts

Frequency Deviation:  $\pm 5$  kHz max + 20 dB limiting @ 1 kHz.

Frequency Response: + 6 dB per octave, 300 kHz Max.

Demodulated S/N: > 40 dB weighted

Modulation:  $\pm 5$  kHz Max.

Current Consumption: High: 1.4 Amp Low: 550 mA

## RECEIVER

---

Receiver Type: Double Conversion Super Heterodyne

Sensitivity: 12 dB SINAD: -120 dBm

IF Frequencies: 1st: 21.4 MHz

2nd: 450 kHz

Modulation Frequency Response: -6 dB per octave 300 Hz–3 kHz, +1–3 dB

Intermodulation Rejection: > 65 dB

Blocking Rejection: > 90 dB

Spurious Rejection: > 65 dB

Audio Output Power: 500 mW @ 8 Ohms

Audio S/N: > 40 dB

Conducted Spurious Emission: > -57 dBm

## MECHANICAL

---

Unit Dimensions: 98 H x 62 W x 30 D mm

Unit Weight: 180 g approx

## ENVIRONMENTAL

---

Water/Dust Resistance: IP54

Temperature Range: -10°C to +60°C

Compass Safe Distance: 200 mm

## EXTERNAL CONNECTIONS

---

Microphone: 3 pin speaker mic

---

**\*All specifications are typical and subject to change without notice or obligation.**

## STANDARD COMMUNICATIONS WARRANTY AGAINST DEFECTS

This warranty against defects is given by Standard Communications Pty Ltd ACN 000 346 814 (We, us, our or GME). Our contact details are set out in clause 2.7.

### 1. Consumer guarantees

- 1.1 Our goods come with guarantees that cannot be excluded under the Australian Consumer Law. You are entitled to a replacement or refund for a major failure and for compensation for any other reasonably foreseeable loss or damage. You are also entitled to have the goods repaired or replaced if the goods fail to be of acceptable quality and the failure does not amount to a major failure.
- 1.2 To the extent we are able, we exclude all other conditions, warranties and obligations which would otherwise be implied.

### 2. Warranty against defects

- 2.1 This warranty is in addition to and does not limit, exclude or restrict your rights under the Competition and Consumer Act 2010 (Australia) or any other mandatory protection laws that may apply.
- 2.2 We warrant our goods to be free from defects in materials and workmanship for the warranty period (see warranty table) from the date of original sale (or another period we agree to in writing). Subject to our obligations under clause 1.2, we will at our option, either

repair or replace goods which we are satisfied are defective. We warrant any replacement parts for the remainder of the period of warranty for the goods into which they are incorporated.

- 2.3 To the extent permitted by law, our sole liability for breach of a condition, warranty or other obligation implied by law is limited
  - (a) in the case of goods we supply, to any one of the following as we decide -
    - (i) the replacement of the goods or the supply of equivalent goods;
    - (ii) the repair of the goods;
    - (iii) the cost of repairing the goods or of acquiring equivalent goods;
  - (b) in the case of services we supply, to any one of the following as we decide –
    - (i) the supplying of the services again;
    - (ii) the cost of having the services supplied again.
- 2.4 For repairs outside the warranty period, we warrant our repairs to be free from defects in materials and workmanship for three months from the date of the original repair. We agree to re-repair or replace (at our option) any materials or workmanship which we are satisfied are defective.

- 2.5 We warrant that we will perform services with reasonable care and skill and agree to investigate any complaint regarding our services made in good faith. If we are satisfied that the complaint is justified, and as our sole liability to you under this warranty (to the extent permitted at law), we agree to supply those services again at no extra charge to you.
- 2.6 To make a warranty claim you must before the end of the applicable warranty period (see warranty table), at your own cost, return the goods you allege are defective, provide written details of the defect, and give us an original or copy of the sales invoice or some other evidence showing details of the transaction.
- 2.7 Send your claim to:  
Standard Communications Pty Ltd.  
Unit B, 22-24 College Street,  
Gladesville, NSW 2111, Australia.  
Tel: (02) 9879 8888  
Fax: (02) 9816 4722  
Email: servadmin@gme.net.au
- 2.8 If we determine that your goods are defective, we will pay for the cost of returning the repaired or replaced goods to you, and reimburse you for your reasonable expenses of sending your warranty claim to us.

### **3. What this warranty does not cover**

- 3.1 This warranty will not apply in relation to:
- (a) goods modified or altered in any way;
  - (b) defects and damage caused by use with non Standard Communications products;
  - (c) repairs performed other than by our authorised representative;
  - (d) defects or damage resulting from misuse, accident, impact or neglect;
  - (e) goods improperly installed or used in a manner contrary to the relevant instruction manual; or
  - (f) goods where the serial number has been removed or made illegal.

### **4. Warranty period**

- 4.1 We provide the following warranty on GME and Kingray products. No repair or replacement during the warranty period will renew or extend the warranty period past the period from original date of purchase.

PRODUCT TYPE	WARRANTY PERIOD
Marine VHF transceivers	1 year



**1300 463 463**    **gme.net.au**

A division of Standard Communications Pty Ltd.

Head Office: PO Box 96, Winston Hills, NSW 2153, Australia.

New Zealand: PO Box 58-446 Botany, Auckland, 2163, NZ. T:(09) 274 0955.

All other international enquires email: [export@gme.net.au](mailto:export@gme.net.au)